

DRIVEWAY EXAMPLE

THIS EXAMPLE IS PROVIDED AS A GENERAL GUIDE. CONSULT THE DOUGLAS COUNTY TRANSPORTATION AND LAND SERVICES BUILDING DIVISION FOR SPECIFIC REQUIREMENTS.

1234 DOUGLAS ST.

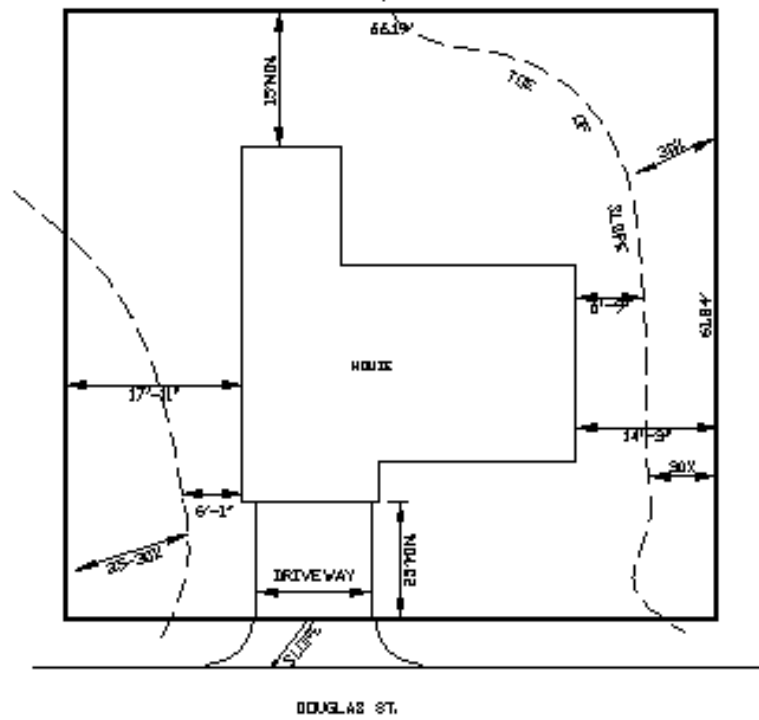

DRIVEWAY SITE PLAN

Slopes of land surfaces or roadbeds are generally expressed in percent of grade. A slope of 5 percent, for instance, rises vertically 5 feet over a horizontal distance of 100 feet.

$$\frac{\text{Rise}}{\text{Run}} \times 100 = \text{Slope (expressed in percent)}$$

$$\text{example: } \frac{5}{50} = .10 \times 100 = 10\%$$

The MAXIMUM allowable slope for a driveway is 12%.

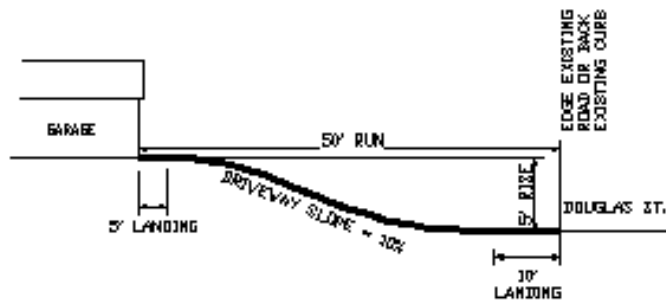

DRIVEWAY PROFILE

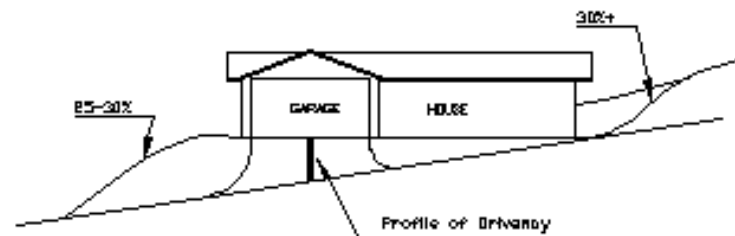

DRIVEWAY ELEVATION

